

Change Record 变更记录

修改说明	Modification description
------	--------------------------

版本	修改日期	修改原因	
1559029-T01-A	2023、6、26	新创建说明书	

卡丽 K A R A T[®]

安装说明书 INSTALLATION INSTRUCTIONS

LOGEN TWO SHOWER THERMO COLUMNS W/ SPOUT
朗睿水玉玄采恒温双花洒淋浴柱，含下出水
30562T-CC1
朗睿水玉月白恒温双花洒淋浴柱，含下出水
30562T-CPW

BEFORE YOU BEGIN

Please read these instruction carefully familiarize yourself with the required tools,materials,and installation sequenes.Follow the sections that pertain to your patticular installation. This will help you avoid costly mistakes.In addition to proper installation,read all operating and safety instructions.
All infromation in these instructions is based upon the latest product infromation available at the time of publication. Karat reserves the right to make changes in product characteristics, packageing, or availability at any time without notice.
These instructions contain important care, cleaning,and warranty information,**please leave instructions for the consumer**

NOTES:

Flush the water supply pipes thoroughly to remove debris. The minimum inlet water pressure for the diverter is 0.05Mpa(0.5bar)

The hightest working pressure foe handspray is 0.5Mpa (5bars). If it exceeds 0.5Mpa(5bars),a pressure reducer is needed. The hightest water and environment temperature is 60°C please keep handspray away from heater,or maybe damage it and hurt user.

安装之前

请仔细阅读说明书，熟悉所需工具、材料和安装顺序，参照相关章节完成您所需的安装，以避免昂贵的损失，除了正确的安装外，请详阅所有的操作和安全说明。

本说明书所含的一切资料均以印刷时所有的最新产品为准，卡丽公司保留权利随时更改产品特性、包装或供应情况，恕不另行通知。

本说明书也包含了有关保养、清洁及产品担保等重要信息-请交予用户保存。

注意事项:

一定要先彻底冲洗供水管以及清除管道中的杂质。
切换阀正常工作的最小水压为：0.05Mpa(0.5bar)。

花洒最高工作水压为0.5Mpa(5bars)，水压超过0.5Mpa (5bars),时需要安装减压阀。花洒最高工作温度及环境温度 为60°C。请特别注意，花洒需远离浴霸，否则可能损坏花洒，甚至对使用者造成伤害。

ROUGHING-IN

Unit:mm

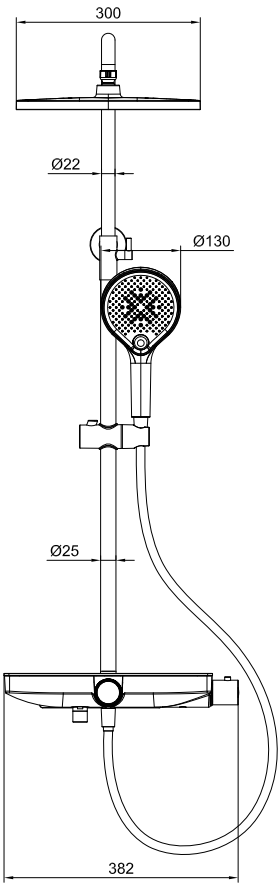

尺寸图

单位: 毫米

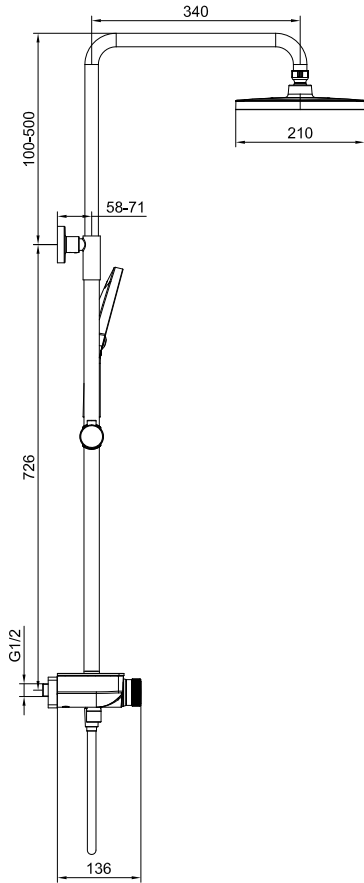

INSTALLATION

安装

1 HOW TO INSTALLATION THE FAUCET
to perform installation ,installer must prvide G1/2 female supply fittings,spaced 150mm apart , level and not extending beyond finished wall surface. Flush the water supply pipes thoroughly to remove any debris .
Install the two offset connectors into the hot and cold supply pipes. Use appropriate thread sealants on pipe threads.
Adjust the center-to -center distance between the connectors to 150mm and level.

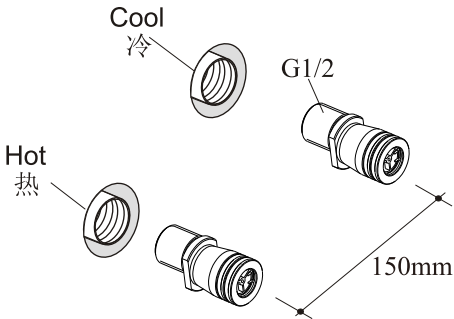

1 安装龙头
为使安装顺利，G1/2内螺纹管道配件应已经安装好，预留150mm的间距，保持水平，不要凸出墙面，彻底清洗供水管，以清除供水管中的杂质。

使用合适的螺纹密封膏，安装两个接头到冷热供水管。

保持两个接头的中心到中心的距离为150mm，并调整到同一水平。

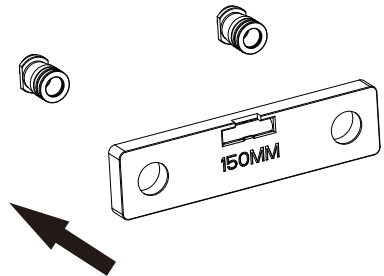

2,HOW TO INSTALL THE COLUMN
On the basis of the centers of the offset connectors, measure 726mm (only for reference, please measure the distance according to the actual dimension of the installed faucet, diverter, slide bar and adjustable base) from the middle of the two connectors and make a mark.
With the mark as the center of the fixing bracket, drill one holes according to the mounting holes in the fixing bracket. Insert the raw plugs into holes. Tighten the fixing bracket with the screws. Fix the cap to the fixing base.

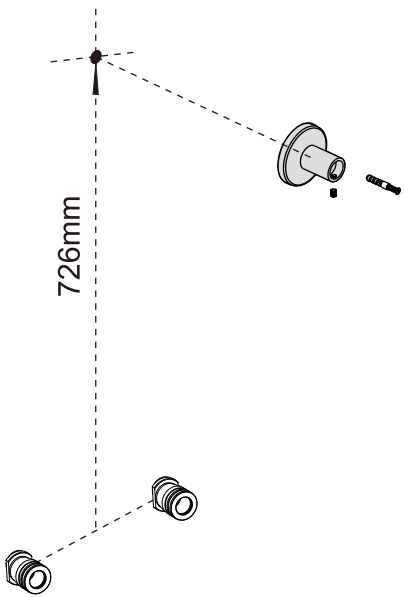

2,如何安装淋浴杆
以接头中心为基准，距离两弯头726mm(仅供参考，以装好的龙头阀体、换向阀、淋浴管、调整座的实际尺寸为准)的中间位置作一标记。
以标记为墙座的圆心基点，以墙座上的螺钉孔为基准在墙上钻一个孔，并打入膨胀管，用螺钉将墙座锁紧于墙上，在调节套上套入装饰盖并按紧。

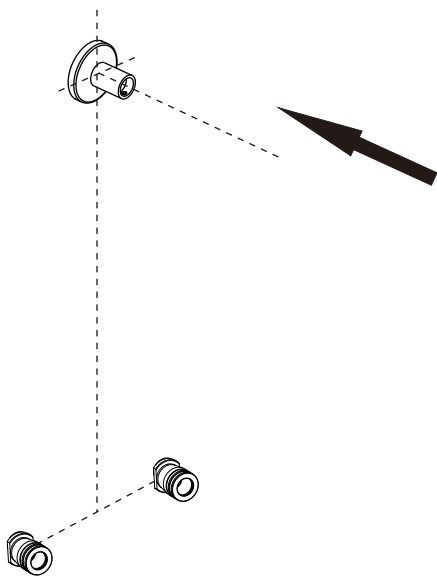

Connect the shelving tap to the wall joint and lock it with screws from the bottom.

Insert the installed slide bar into the nut of the faucet and tighten the nut.

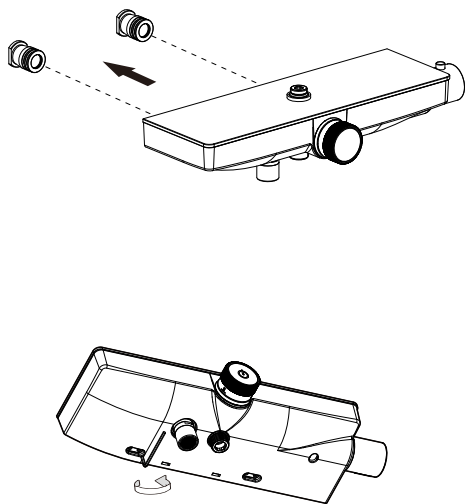

将置物架龙头与墙上接头连接，从底部用螺丝锁紧。

将装好的直杆插入龙头的锁紧螺母中，并将锁紧螺母锁紧。

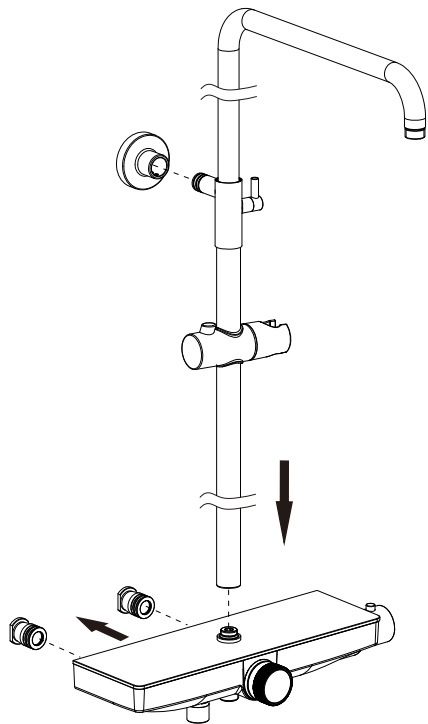

Insert the Tighten Bracket tube of the adjustable base into the fixing base . Adjust the distance between the slide bar and the finished wall and tighten the nut in the fixing base.

将锁紧支架直管部分插入锁紧底座，调整好直杆与墙面的距离并在调节套上锁紧固定螺母。

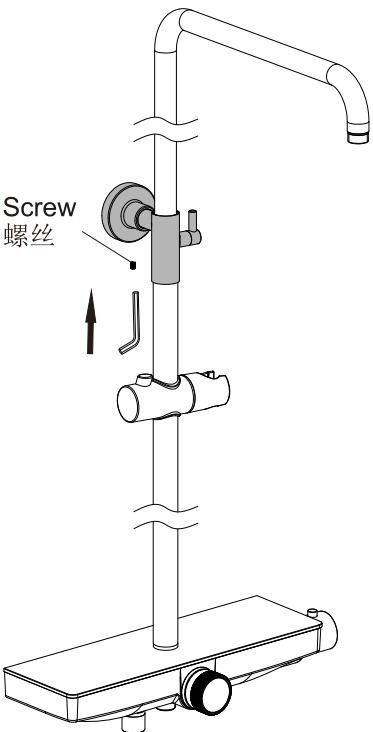
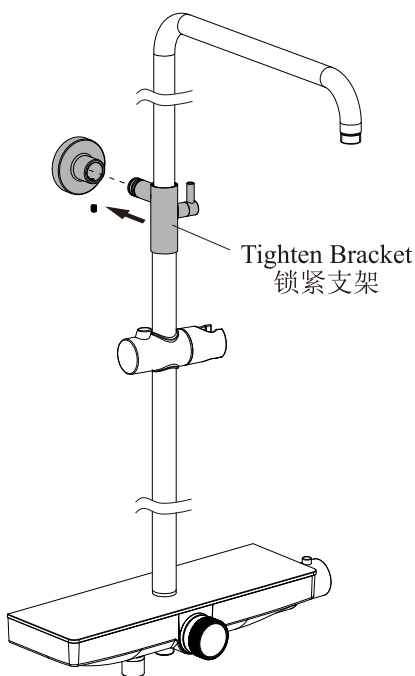

3, HOW TO INSTALL THE SHOWER

Flush both water supplies through the shower arm for one minute before the showerhead is installed. Apply or sealant to the exposed end of the shower arm. Tighten the showerhead with a strap wrench.

Before installation, install c if needed .take out washer and install restrictor as the figure shown, reinstall washer.

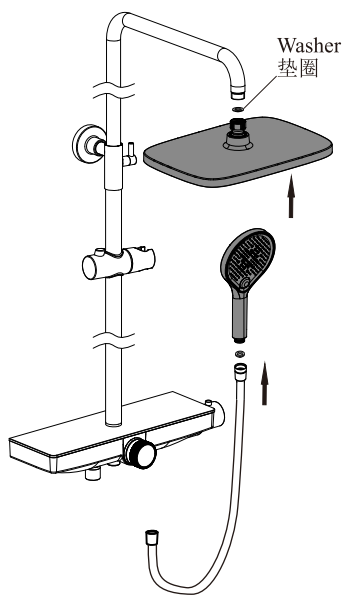

3, 如何安装花洒

装花洒头之前，先打开水源冲掉杂质。在花洒臂螺纹上缠绕足以密封的密封胶带或涂合适的密封胶，将花洒头旋到花洒臂上。

在装花洒之前可根据需要安装限流器。先取出垫片，按图示方向放入限流器，再装回垫片。

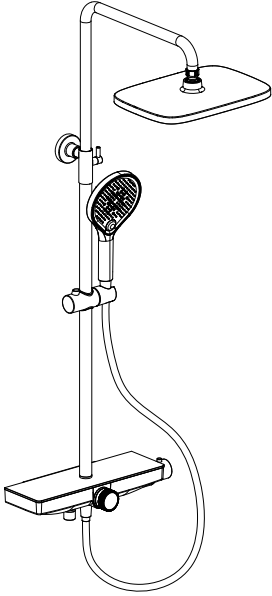

HANDLE OPERATION

Use of thermostat handwheel: Turn the thermostat handwheel on the right to adjust the water temperature. clockwise for low temperature. counterclockwise for high temperature. (Press the anti-scalding button to turn the handwheel in the direction of high temperature when it reaches 40 from low temperature to high temperature).

Use of the switch button: press down for water state. flip up for off state.

Use of water distributing hand wheel: Turn the water distributing hand wheel clockwise in the corresponding outlet sequence: Spout→Shower Head→Shower spray.

使用说明

调温手轮的使用：转动右边的调温手轮调节出水温度，顺时针转动为低温，逆时针转动为高温；（由低温往高温方向转动到40处需按下防烫按钮才能往高温方向转动手轮）。

开关按钮的使用：按下为出水状态，弹起为关闭状态。

分水手轮的使用：顺时针旋转分水手轮对应的出水顺序：出水嘴→头部花洒→手持花洒。

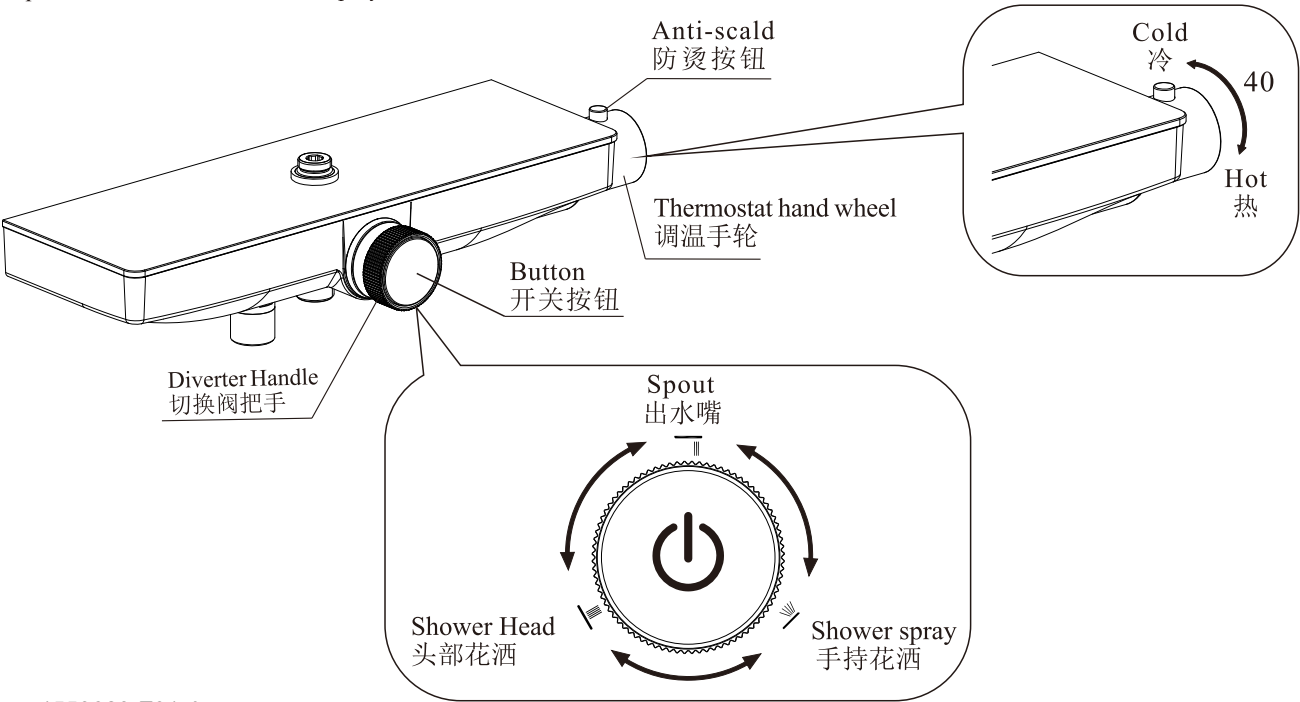

CLEANING INSTRUCTIONS

All finishes : clean the finish with a mild soap and warm water. wipe entire surface completely dry with a clean soft cloth. Many cleaners may contain chemicals , such as ammonia chlorine, toilet cleaner etc., Which could adversely affect the finish and are not recommended for cleaning.
Don't use abrasive cleaner or solvents on karat faucets and fitting.

清理说明

适用于所有加工处理过的表面：
以中性肥皂水清洗镀层表面，再以干净的软布彻底擦干整个表面。许多清洁剂，比如氨水、去污粉及洁厕灵等，会对电镀表面造成伤害，切勿使用。

有腐蚀性的清洁剂或溶剂不可使用于卡丽的水龙头及其附件上。

Limited Warranty

Karat warrants its product to be leak and drip during normal residential usage for five (5) years from date of purchase.If the product should leak or drip during normal residential use, Karat will, free of charge, mail to the purchaser the cartridge necessary to put the product in good working condition.Normal residential useconditions do not include water supply temperature below 0 ° C, excessive impurities in the water, and overly hard water quality.This warranty only applies to Karat product purchased and installed in mainland China.
Karat also warrants all other aspects of the product or accessories and finishes to be free of defects in material and workmanship for five (5) years from date of purchase. Karat will, at its election, repair, replace, or make appropriate adjustment where Karat inspection discloses any such defects occurring in normal use during the warranty period. Karat is not responsible for removal or installation costs. Damage caused by accident, misuse, or abuse is not covered by this warranty. Improper care and cleaning will void the warranty.
If this product is used commercially, Karat warrants the product to be free from defects in material and workmanship for one (1) year from the date of purchase, with all other terms of this warranty applying except duration.
If you believe that you have a warranty claim, contact Karat through your Dealer, Plumbing Contractor, Home Center, or E-tailer. Please be sure to provide all pertinent information regarding your claim, including a complete description of the problem, the product, model number, color, finish, the date the product was purchased and from whom the product was purchased. Also include your proof of purchase (original sales receipt).
KARAT AND/OR SELLER ARE PROVIDING THESE WARRANTIES IN LIEU OF ALL OTHER WARRANTIES, EXPRESSED OR IMPLIED, INCLUDING BUT NOT LIMITED TO THE IMPLIED WARRANTIES OF MERCHANTABILITY AND FITNESS FOR A PARTICULAR PURPOSE. KARAT AND/OR SELLER DISCLAIM ALL LIABILITY FOR SPECIAL, INCIDENTAL OR CONSEQUENTIAL DAMAGES.
This is Karat's exclusive written warranty.

有限担保

卡丽担保本产品在正常家用的情况下自购买之日起五年内不存在由阀芯造成的龙头滴漏现象。上述担保期内，如本产品在日常家用情况下出现滴漏，卡丽将为客户更换新的阀芯，令其恢复正常状态。正常家用情况不包括：供水温度低于0°C、水中的杂质过多、水质过硬的情况。本担保仅适用于在中国大陆购买并安装的卡丽产品。

卡丽同时担保，本产品的其他部分或配件及涂层在日常家用的情况下自购买之日起五年内无材料及制造工艺上的瑕疵。在上述担保期内，如经卡丽核查后发现产品在正常使用情况下存在瑕疵，卡丽将自行决定对产品进行修理、更换、或是作适当的调整。卡丽不承担上述成本以外的人工成本、拆除或安装的成本。由于意外、过度使用或或使用不当造成的产品损害不属于担保范围之内。不适当的保养和清洁将导致担保无效。

如产品被用于商业目的，则卡丽担保该产品自购买之日起一年内无材料及制造工艺上的瑕疵。除担保期限以外，本担保的其他条款均适用。

为获得担保服务，请通过您的经销商、承包商、家居中心或网络零售商联系我们。请确保提供所有相关的信息，包括完整的问题描述、型号、颜色、表面镀层、购买时间及销售方。请务必同时提供购买凭证（原销售发票）。

在法律允许的范围内，卡丽及/或销售商提供此担保以取代所有其他明示或默示的担保（包括但不限于产品的适销性和适用于特定目的的担保），并且卡丽及/或销售商对任何特殊、附带或衍生性损害赔偿不承担责任。

这是我们全部的书面担保。

Shanghai Chehe Trading Co., Ltd.
Address: 2nd floor, No. 126,128,130 Jiangchang San Road,
Jing 'an District, Shanghai
Tel: 400-920-8262
Postcode:200436

上海澈和贸易有限公司
地址：上海市静安区江场三路126、128、130号2层
电话： 400-920-8262
邮编： 200436

卡丽 K A R A T®
维修零件图 SERVICEPARTSPAGE

LOGEN TWO SHOWER THERMO COLUMNS W/ SPOUT
朗睿水玉玄采恒温双花洒淋浴柱，含下出水
30562T-CC1
朗睿水玉月白恒温双花洒淋浴柱，含下出水
30562T-CPW

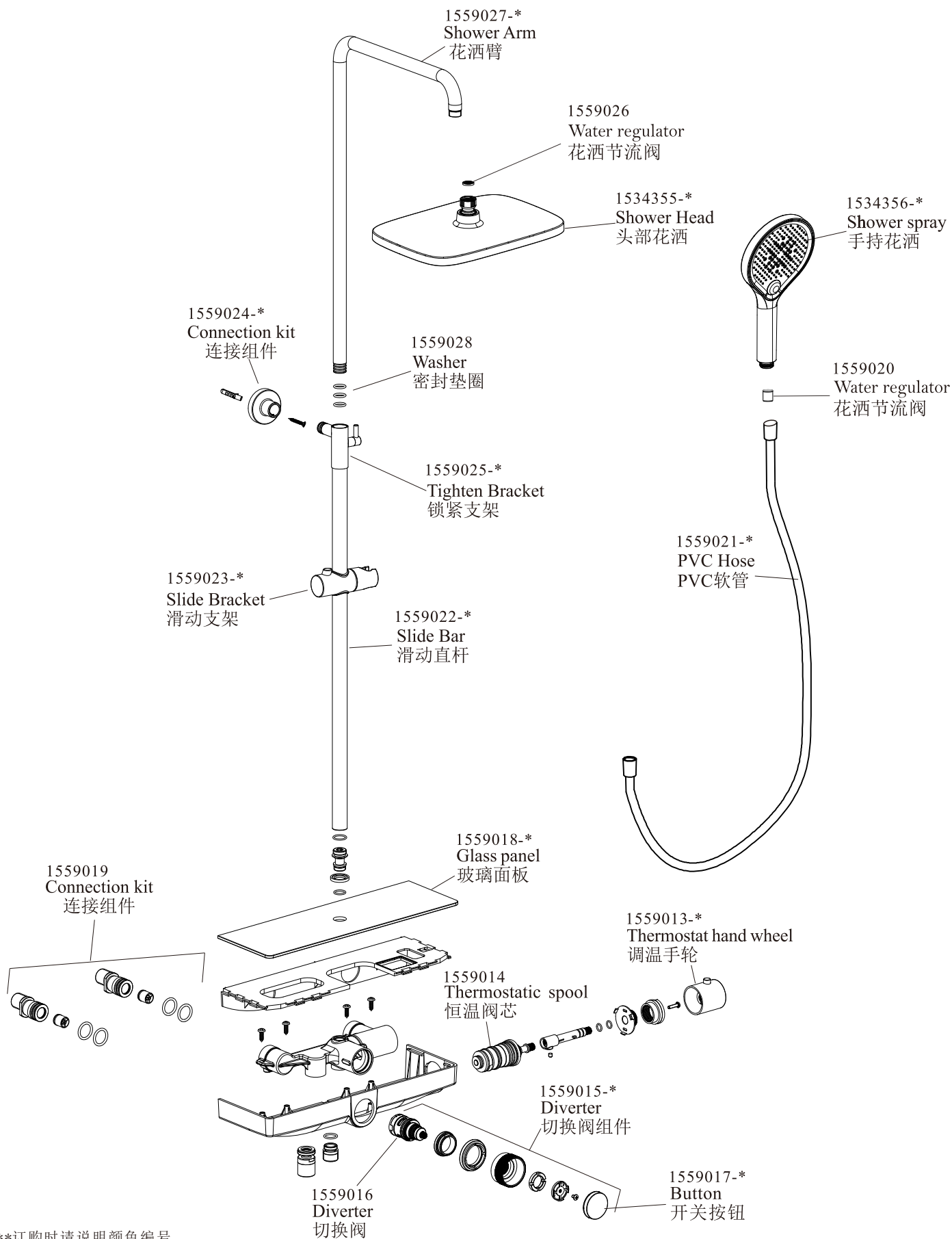

**订购时请说明颜色编号
**Color code must be specified when ordering