

# 卡丽 KARAT®

## 安装说明书 INSTALLATION INSTRUCTIONS

卡丽滑动花洒支架  
KARAT SHOWER SLIDE BAR  
14976T-CP

### BEFORE YOU BEGIN

Please read these instruction carefully familiarize yourself with the required tools, materials, and installation sequences. Follow the sections that pertain to your particular installation. This will help you avoid costly mistakes. In addition to proper installation, read all operating and safety instructions.

All information in these instructions is based upon the latest product information available at the time of publication. Karat reserves the right to make changes in product characteristics, packaging, or availability at any time without notice.

These instructions contain important care, cleaning, and warranty information, **please leave instructions for the consumer**

### 安装之前

请仔细阅读说明书，熟悉所需工具、材料和安装顺序，参照相关章节完成您所需的安装，以避免昂贵的损失，除了正确的安装外，请详阅所有的操作和安全说明。

本说明书所含的一切资料均以印刷时所有的最新产品为准，卡丽公司保留权利随时更改产品特性、包装或供应情况，恕不另行通知。

本说明书也包含了有关保养、清洁及产品担保等重要信息，请交予用户保存。

### ROUGHING-IN

Unit:mm

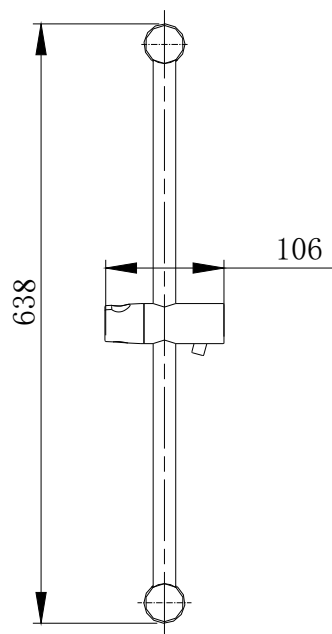

### 尺寸图

单位: 毫米

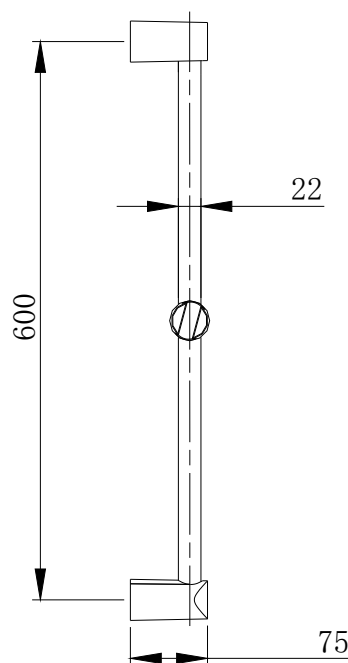

## 1 HOW TO INSTALLATION THE BRACKET

Mark bracket base mounting hose location on the wall.  
Drill two hose in the finish wall as required. A hole  
whose diameter is 6mm and the depth is 40mm.  
press the anchors into the hose

**NOTE:** All holes should be in line, at a distance of  
555 mm from each other.

## 1 安装支架

在淋浴软管可及的高度选择一个安装滑杆的位置。在墙  
壁上标上安装支架底板位置的标记，按标记钻两个洞。  
孔的直径为6mm,深为40mm。将膨胀塞插入孔中。

**注意:**安装孔必在一条直线上,距离为615mm。

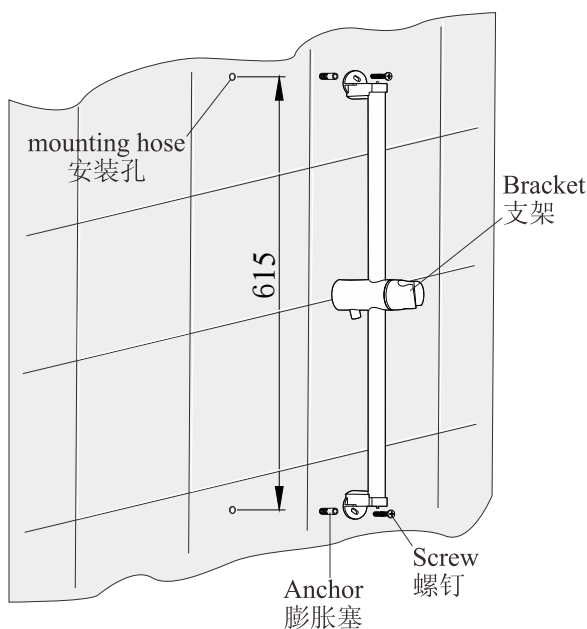

As is shown in the picture, screw the self-tapping  
screws into the anchors though the sleeve. Tighten  
them by screwdriver.

按照图示将自攻螺钉旋入膨胀塞中，用螺丝刀拧紧。

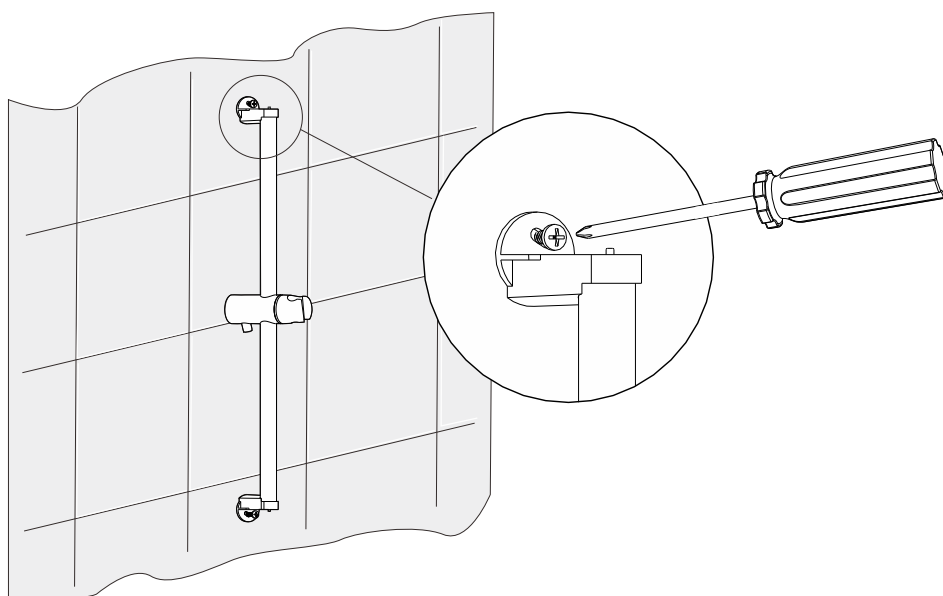

As is shown in the picture, Slide the bracket and onto the sleeve and insert the locking pin into the hole of the bracket and sleeve.

按照图示将支架盖内壁的凹槽对准底板的凸台插入。

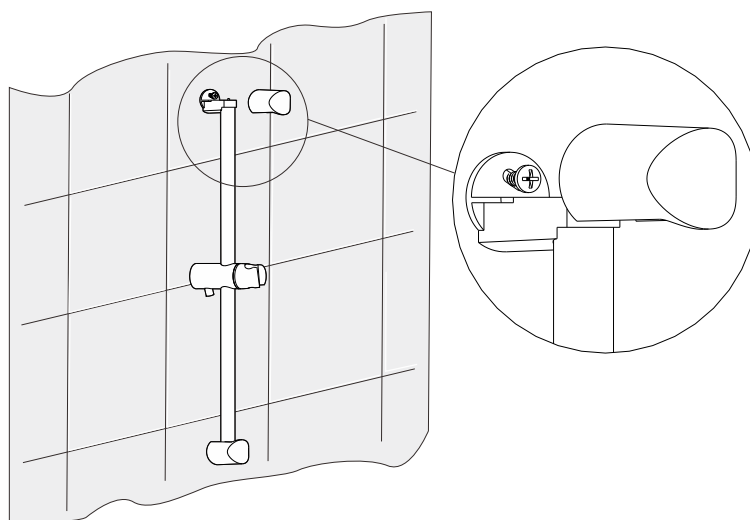

## CLEANING INSTRUCTIONS

## 清理说明

All finishes : clean the finish with a mild soap and warm water. wipe entire surface completely dry with a clean soft cloth. Many cleaners may contain chemicals , such as ammonia chlorine, toilet cleaner etc., Which could adversely affect the finish and are not recommended for cleaning.

Don't use abrasive cleaner or solvents on karat faucets and fitting.

适用于所有加工处理过的表面:

以中性肥皂水清洗镀层表面，再以干净的软布彻底擦干整个表面。许多清洁剂，比如氨水、去污粉及洁厕灵等，会对电镀表面造成伤害，切勿使用。

有腐蚀性的清洁剂或溶剂不可使用于卡丽的水龙头及其附件上。

## ONE -YEAR WARRANTY

## 一年有限担保

We warrant all other aspects of its bracket to be free of defects of material and workmanship during normal residential use for one year. Our company will be responsible any problems caused by manufacturing defects provided with the invoice. Our company will, at its election ,repair ,replace or make appropriate adjustment where our company inspection discloses any such defects occurring in normal usage within warranty.

本产品自购买之日起，在正常使用下提供一年的质量担保。在质保期内，凭购货发票，我司将免费承担由制造质量引起的任何问题。经核查后，我司有权决定是修理、更改、还是做适当的调整。

The warranty, including products, is limited clearly. Our company is not responsible for other damages appeared after the warranty. Also, the warranty does not cover problems arising from labor charges, incorrect use and installation.

这里的担保，包括产品都已明确地限制在该担保期内。本公司对以后出现的损坏不负有任何责任。担保也不包括外观损伤，使用不当及未按说明书安装的损失。

Shanghai Kohler International Trade Co., Ltd.  
Address: Room 1348, Floor 13, No. 55, Xi Li Road,  
China (Shanghai) Pilot Free Trade Zone  
Tel: 400-920-8262  
Postcode: 200131

上海科勒国际贸易有限公司  
地址：中国(上海)自由贸易试验区西里路55号13层1348部位  
电话：400-920-8262  
邮编：200131

