

# 卡丽 K A R A T®

## 安装说明书 INSTALLATION INSTRUCTIONS

### SPRINKLE TOW SHOWER COLUMNS

悦霖玄采双花洒淋浴柱

26863T-CC1

#### BEFORE YOU BEGIN

- please carefully read this installation instruction in order to ensure proper care and assembly of this accessory.
- Please keep this installation instruction for future reference.



Prior to drilling into walls, check there are no hidden electrical wires, cables or water supply pipes with the aid of an electronic detector. If you use power tools do not forget:

1. Wear eye protection.
2. Unplug equipment after use.

#### 安装之前

- 在您安装之前请仔细阅读此说明书。
- 请保留此说明书以备参考。



警示：在钻孔之前，请借助电子探测仪确认墙内是否有电源线，通讯光缆或者水管之类的东西。如果使用电钻的话请勿忘记以下两点：

1. 请戴上防护镜。
2. 用完设备后关掉电源。

#### TOOLS AND ACCESSORIES

#### 工具及配件

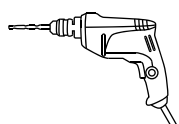

Drill  
电钻

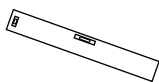

Leveling Instrument  
水平尺

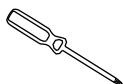

Screw Driver  
螺丝刀

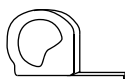

Tape  
卷尺

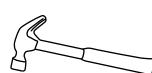

Hammer  
锤子

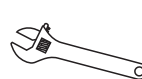

Monkey Spanner  
活动扳手



Teflon Tape  
生料带

#### ROUGHING-IN

#### 尺寸图

Reference Value  
参考值

Unit: mm  
单位: 毫米

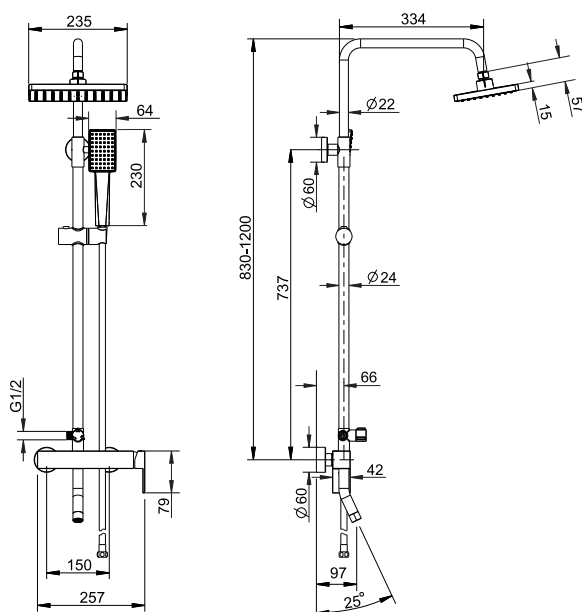

公司保留随时变更图中标示尺寸的权利，无需另行通知。  
Our company reserves the right to change marked dimensions without prior notice.

## INSTALLATION

1. Install the two offset connectors into the hot and cold supply pipes. Joints should be installed on the pipe thread wrapped with the appropriate Teflon tape to ensure the reliability of sealing. Adjust the center-to-center distance between the connectors to 150mm and level. Thread the trim caps onto the connectors so that the trim caps caps contact the finished wall.

1. 接头安装时管螺纹上应缠绕适当的生料带，以确保其密封的可靠性，安装两个接头到冷热供水管。保持两个接头的中心到中心的距离为150mm，并调整到同一水平。把装饰盖旋入接头，紧贴墙面。

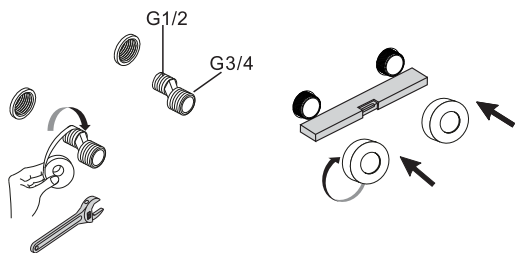

## 安装

2. Measure the height, mark the fixed position of the wall base on the wall, and drill holes according to the mark. Insert the expansion plug into the hole, then screw the self tapping screw into the expansion plug and tighten with a screwdriver

2. 测量好高度，在墙壁上标上安装固定墙座位置的标记，按标记钻洞。将膨胀塞插入洞中，然后将自攻螺丝旋入膨胀塞中，用螺丝刀拧紧。

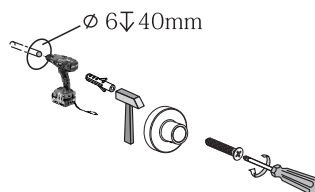

3. Put the sealing gasket into the tap nut, screw the nut onto the joint and tighten it

3. 将密封垫片放入龙头螺母内，把螺母扭上接头上，并拧紧。

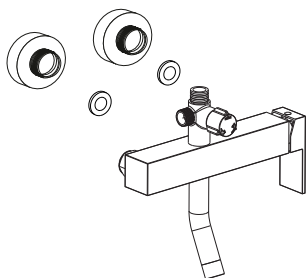

4. Slide sleeve into straight pipe.

4. 将滑套套进直管。



5. Screw the elbow assembly into the straight pipe group.

5. 将弯管组旋入直管组。

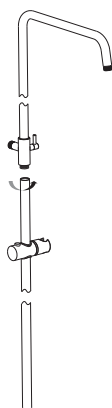

6. Insert the straight pipe into the faucet.

6. 将直管对齐插入水龙头。

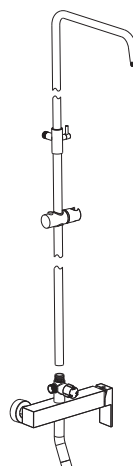

7. Insert the shower pipe adjusting joint into the fixed wall base, and tighten the two hexagon screws with the hexagon wrench

7. 将淋浴管调整接头插入固定墙座，用内六角扳手将两颗内六角螺丝拧紧。

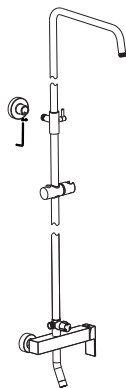

8. Install the gasket on the shower hose, connect one end of the shower hose to the water outlet of the faucet, connect the other end with the hand-held shower, and twist the top spray into the elbow outlet.

8. 将垫片安装在淋浴软管接进水一头，把淋浴软管一头接到龙头出水口，另一头接手持花洒，顶喷扭入弯管出水口。

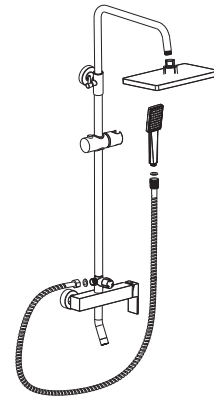

## HANDLE OPERATION

## 使用说明

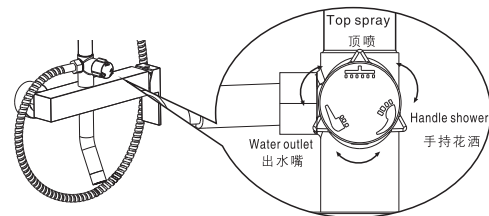
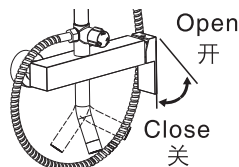
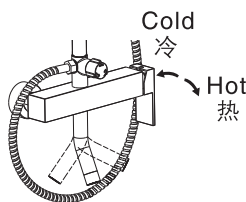

## CARING FOR YOUR PRODUCTS

## 使用须知

1. Clean the product daily with cotton cloth. Do not use abrasive materials.
2. Do not use strong chemical detergents such as strong acid, strong alkali or phosphoric acid.
3. Avoid scratching product surface with sharp objects.

1. 要经常除尘，因为灰尘每天都会粘在产品表面。最好使用干净的纯棉针织品作为抹布。  
切记：请避免使用粗，磨料和钢丝球擦拭。
2. 请勿使用强力化学剂清洁（强酸，强碱或磷酸消毒剂）。
3. 产品均经过表面的打磨和抛光处理，避免有尖锐的硬物刮碰表面。

## FIVE-YEARS WARRANTY

## 五年有限担保

Our company provides five years warranty for its faucets valve to be leak and drip free during normal residential use. We also warrant all other aspects of its faucets to be free of defects of material and workmanship during normal residential use for one year. Our company will be responsible any problems caused by manufacturing defection, repair, replace or make appropriate adjustment when our company inspection discloses any such defects occurring in normal usage within warranty.

The warranty, including products, is limited clearly. Our company is not responsible for other damages appeared after the warranty. Also, the warranty dose not cover problems arising from labor charges, incorrect use and installation.

本产品自购买之日起，在正常使用下任何由阀芯造成的龙头滴漏现象，我司将提供长达五年的质量担保，同时对正常使用下的龙头制造和质料上的瑕疵提供一年的质量担保。在质保期内，凭购货发票，我司将免费承担由制造质量引起的任何问题。经核查后，我司有权决定是修理、更改、还是做适的调整。

这里的担保,包括产品都已明确地限制在该担保期内，本公司对以后出现的损坏不负任何责任，担保也不包括外观损伤，使用不当及未按说明书安装的损失。

Shanghai Kohler International Trade Co., Ltd.  
Address: Room 1348, Floor 13, No.55, Xi Li Road,  
China (Shanghai) Pilot Free Trade Zone  
Tel: 400-920-8262  
Postcode: 200131

上海科勒国际贸易有限公司  
地址：中国（上海）自由贸易试验区西里路55号13层1348部位  
电话：400-920-8262  
邮编：200131

# 卡丽 KARAT

## 安装说明书 INSTALLATION INSTRUCTIONS

### SPRINKLE TOW SHOWER COLUMNS

悦霖玄采双花洒淋浴柱

26863T-CC1

